

POOLE BASIN MONO



DOMESTIC



0.1 - 0.2 BAR



0.5 - 5.0 BAR



PRODUCT INFORMATION

CORP005

Poole Large Freestanding Basin Mono - 0.5 bar waste not included

CORP002

Poole Basin Mono including 1 1/4" click clack basin waste - 0.2 bar

RELATED PRODUCTS IN RANGE

CORP003

Poole Bath Filler - 0.5 bar

CORP004

Poole Bath Shower Mixer including handset - 0.5 bar

SPECIFICATIONS

Minimum operating pressure as per product information

1/4 turn ceramic disc technology

MATERIAL COLOUR/FINISH APPROVALS

Brass

Chrome

This product should be fitted in accordance with relevant *Water Byelaw Regulations*

Deck mounted using back nuts provided
(do not overtighten)

FIXING

PRODUCT DIMENSIONS ADDITIONAL INFORMATION

Please refer to technical line drawing

Suitable for the following plumbing systems:
Gravity fed, pumped, unvented or combi systems.

For a full range of brassware products please refer to
www.sonasbathrooms.com

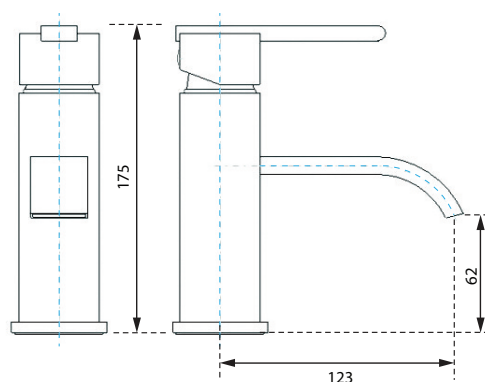
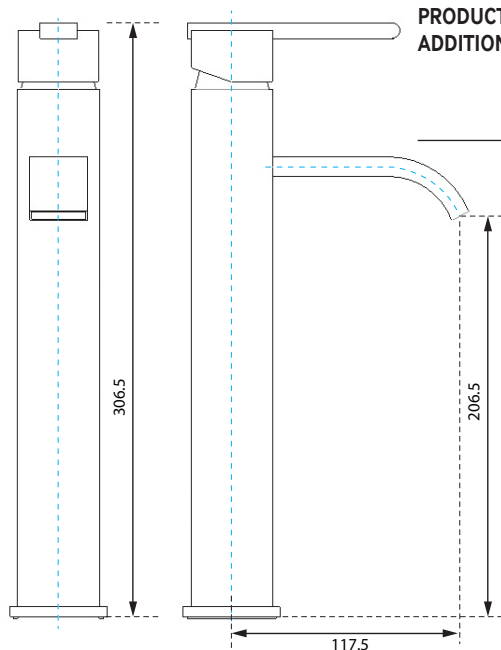

WARRANTY

- **5 year warranty** on taps applies to chrome finish and main body of products. All surfaces must be cleaned with warm soapy water and dried with soft clothes only. The use of abrasive cleaners or materials will render *warranty invalid*. Flexible tail connections, hoses and handsets are covered by a *1 year guarantee*.
- **Do not over tighten** flexible tail connections as this may result in later failure of the fitting.
- To enable each supply to be individually isolated product should be fitted with individual isolating valves, claims will be dealt with on that basis.
- Suitable access should be provided in order for products or parts to be replaced under warranty. In the event that *no access* is provided, labour cost claims *cannot* be upheld.

